

# TERNA S 45

## LOG BOILERS



Terna boiler are equipped with a double firebox where it is possible to burn wood on one side and gas or gasoil on the other, in order to guarantee the operation once the wood charge is over. It is possible to burn big quantities of logs thanks to the wide firebox, the structure is extremely solid and the dimensions are measured. Its easy manufacturing project allows the end user to have a simple maintenance of the unit.

Heatable area

414 m<sup>2</sup>.





- 1 - High heat exchange thanks to the wide water jacket
- 2 - Double smoke outlet with separated exit and inspection
- 3 - Pipes heat exchanger with Thermocore system
- 4 - Secondary air control
- 5 - Cast iron grate with riddle system
- 6 - Centrifugal fan for primary air input
- 7 - Primary air flow adjusting patented system
- 8 - Removable wide ash pan
- 9 - Double separated smoke outlets (only TERNA S and TERNA B)



## OPTIONAL ACCESSORIES

---



## DIMENSIONS

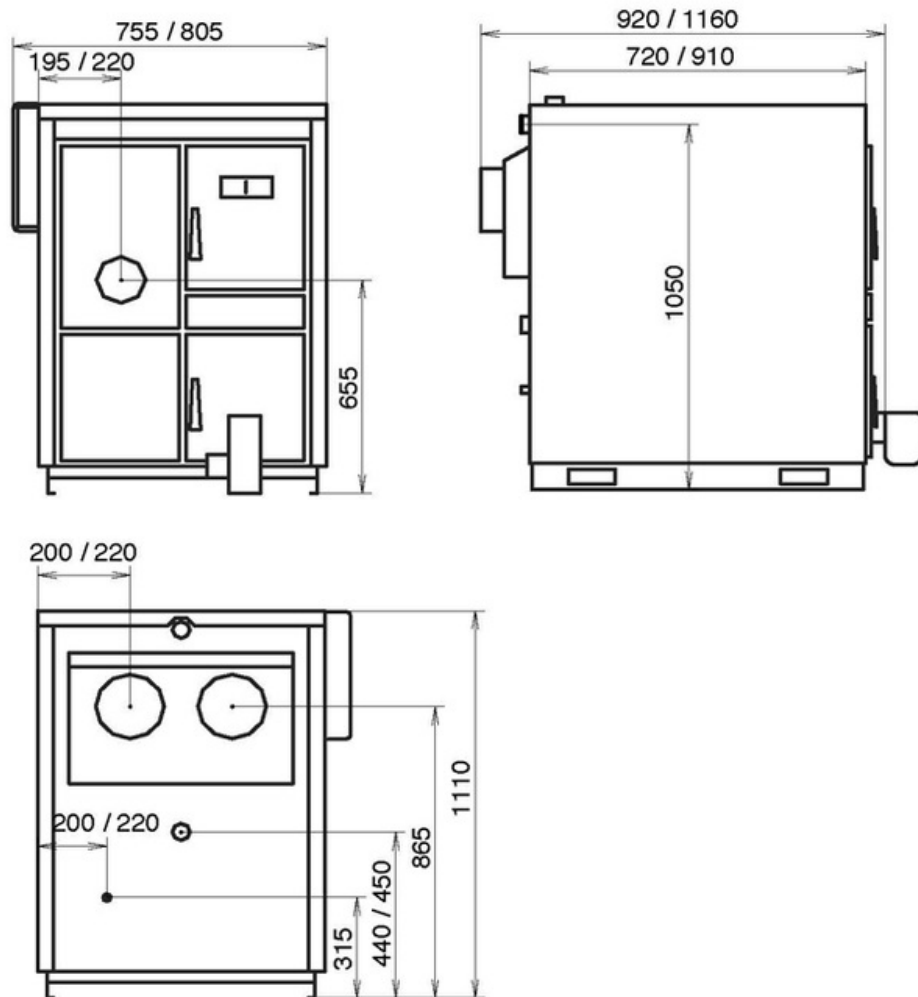

## TECHNICAL DATA

DIMENSIONS (HXWXD)	1110X945X1160
WEIGHT (KG)	450
HEATABLE AREA (M²)*A°C	414
EFFICIENCY UP TO MAX (%)*A	79,3%
ENERGY CLASS	A
POWER TO THE HEART (KW)*A	58,0
RATED POWER (KW)*A	46,0
POWER TO THE WATER (KW)*A	46
RADIATION (KW)*A	-
HOURLY PELLET CONSUMPTION (KG/H)*A	-
WOOD HOURLY CONSUMPTION (KG/H)*A	0 - 13,8
PELLET HOPPER CAPACITY (KG)*A	
WARM AIR DUCTING	-
MAXIMUM SINGLE DUCTING OUTLET (M)	-
PATENTED BURNER PELLETPOWER®	
ROOM VENTILATION	-
PRIMARY AIR FROM OUTSIDE	-
CO EMISSIONS (MG/M³; 13% OF O2)*A	

CO EMISSIONS (MG/M <sup>3</sup> ; 10% OF O <sub>2</sub> )*A	-
DUST EMISSIONS (MG/M <sup>3</sup> ; 13% OF O <sub>2</sub> )*A	-
DUST EMISSIONS (MG/M <sup>3</sup> ; 10% OF O <sub>2</sub> )*A	-
SILENCE (DB)	-
REMOTE CONTROL	-
RADIO CONTROL WITH ROOM TEMPERATURE THERMOSTAT	-
WEEKLY PROGRAMMER (3 DAILY LIGHTING)	-
«SMART INFO» FUNCTION	-
SYSTEM CIRCULATING PUMP	-
EXPANSION TANK	-
OVER PRESSURE VALVE	-
FLUE GASEXHAUST DIAMETER (MM)	200/200
MIN. FLUE DRAUGHT PRESSURE (PA)	25
ELECTRIC CONSUMPTION (WATT)	-
HIGH TEMPERATURE SAFETY THERMOSTAT	-

\*A EMISSIONS AND PERFORMANCE DATA MAY CHANGE ACCORDING TO THE FUEL USED. THE VALUES OF PELLET PRODUCTS HAVE BEEN OBTAINED BY USING CERTIFIED FUEL ACCORDING TO EN 14961-2 A1-A2 NORM. WOOD LOGS PRODUCTS VALUES MAY VARY ACCORDING TO THE TYPE AND QUALITY OF THE WOOD LOGS USED.

\*B PROVISIONAL DATA UNDER CERTIFICATION

\*C IMPORTANT: WHEN CALCULATING THE VOLUME OF THE "HEATED AREA" SOME RELEVANT ASPECTS MUST BE CONSIDERED: INSULATION OF THE BUILDING (ENERGY CLASS), POSITION OF THE HEATER, CLIMATIC AREA AND MORE ASPECTS THAT CAN AFFECT THE VALUES OF PERFORMANCE. REPORTED DATA HAVE BEEN CALCULATED ON THE BASE OF ROOF NOT HIGHER THAN 3 MTS.

THE MANUFACTURER RESERVES THE RIGHT TO MAKE CHANGES WITHOUT PREVIOUS NOTICE.

THERMOROSSI S.p.A.

Via Grumolo, 4 | 36011 Arsiero (VI) | Italy | E-mail: [info@thermorossi.it](mailto:info@thermorossi.it)

Tel: 800.44.88.77 | Fax: 0445 741657 | P.IVA 00168470243 | Iscr. REA99797 Vicenza | Cap. Sociale di 156,000,00 I.v.