

TERNA S 27

LOG BOILERS



The double firebox boiler TERNA S and the double firebox +boiler tube TERNA B, are a logical addition to the heating system. The firebox of the TERNA S model is identical to the one installed in SIRIO for burning solid fuels such as wood, coal, compressed briquettes, etc. A second firebox has been installed next to this one, separated from the smoke side but communicating with the water side, that makes it possible to install a fan assisted gas or diesel oil burner to guarantee heating continuity when the solid fuel fire goes out.



Heatable area

252 m².



- 1 - High heat exchange thanks to the wide water jacket
- 2 - Double smoke outlet with separated exit and inspection
- 3 - Pipes heat exchanger with Thermocore system
- 4 - Secondary air control
- 5 - Cast iron grate with riddle system
- 6 - Centrifugal fan for primary air input
- 7 - Primary air flow adjusting patented system
- 8 - Removable wide ash pan
- 9 - Double separated smoke outlets (only TERNA S and TERNA B)



OPTIONAL ACCESSORIES



DIMENSIONS

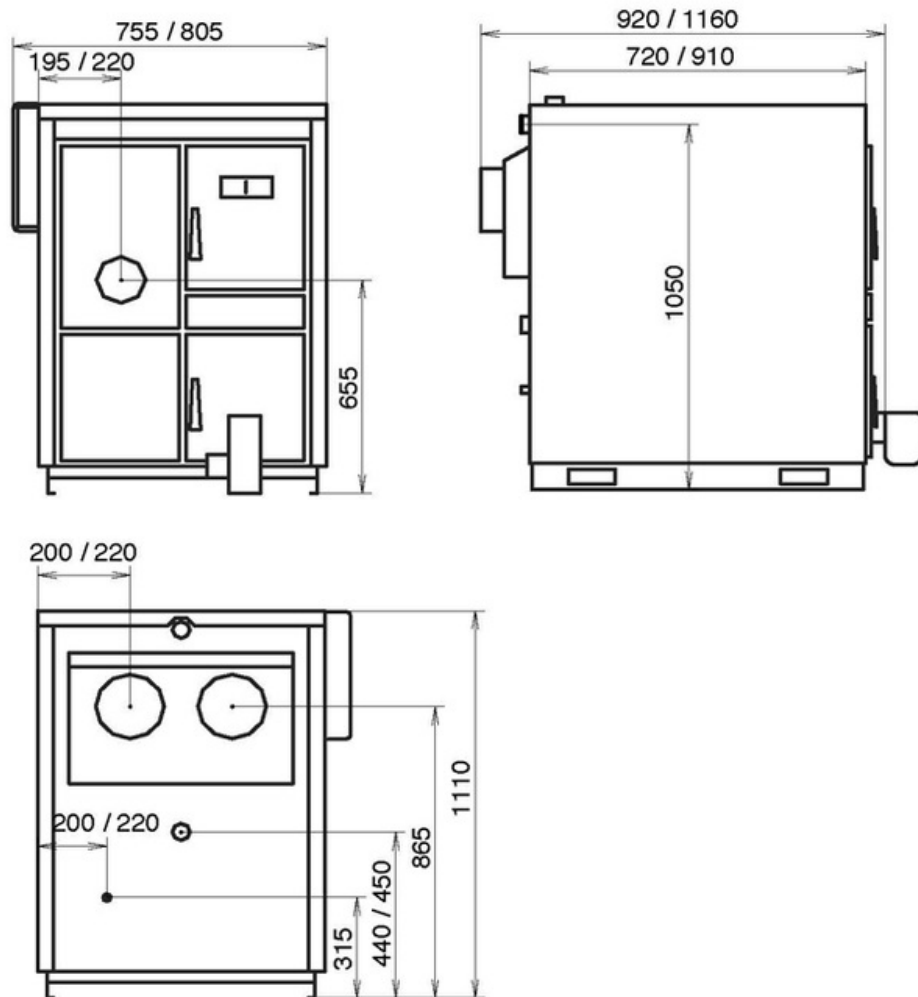

TECHNICAL DATA

DIMENSIONS (HXWXD)	1110X895X920
WEIGHT (KG)	333
HEATABLE AREA (M²)*A°C	252
EFFICIENCY UP TO MAX (%)*A	80,0%
ENERGY CLASS	A
POWER TO THE HEART (KW)*A	35,0
RATED POWER (KW)*A	28,0
POWER TO THE WATER (KW)*A	28
RADIATION (KW)*A	-
HOURLY PELLET CONSUMPTION (KG/H)*A	-
WOOD HOURLY CONSUMPTION (KG/H)*A	0 - 8,3
PELLET HOPPER CAPACITY (KG)*A	
WARM AIR DUCTING	-
MAXIMUM SINGLE DUCTING OUTLET (M)	-
PATENTED BURNER PELLETPOWER®	
ROOM VENTILATION	-
PRIMARY AIR FROM OUTSIDE	-
CO EMISSIONS (MG/M³; 13% OF O2)*A	

CO EMISSIONS (MG/M ³ ; 10% OF O ₂)*A	-
DUST EMISSIONS (MG/M ³ ; 13% OF O ₂)*A	-
DUST EMISSIONS (MG/M ³ ; 10% OF O ₂)*A	-
SILENCE (DB)	-
REMOTE CONTROL	-
RADIO CONTROL WITH ROOM TEMPERATURE THERMOSTAT	-
WEEKLY PROGRAMMER (3 DAILY LIGHTING)	-
«SMART INFO» FUNCTION	-
SYSTEM CIRCULATING PUMP	-
EXPANSION TANK	-
OVER PRESSURE VALVE	-
FLUE GASEXHAUST DIAMETER (MM)	200/200
MIN. FLUE DRAUGHT PRESSURE (PA)	25
ELECTRIC CONSUMPTION (WATT)	-
HIGH TEMPERATURE SAFETY THERMOSTAT	-

*A EMISSIONS AND PERFORMANCE DATA MAY CHANGE ACCORDING TO THE FUEL USED. THE VALUES OF PELLET PRODUCTS HAVE BEEN OBTAINED BY USING CERTIFIED FUEL ACCORDING TO EN 14961-2 A1-A2 NORM. WOOD LOGS PRODUCTS VALUES MAY VARY ACCORDING TO THE TYPE AND QUALITY OF THE WOOD LOGS USED.

*B PROVISIONAL DATA UNDER CERTIFICATION

*C IMPORTANT: WHEN CALCULATING THE VOLUME OF THE "HEATED AREA" SOME RELEVANT ASPECTS MUST BE CONSIDERED: INSULATION OF THE BUILDING (ENERGY CLASS), POSITION OF THE HEATER, CLIMATIC AREA AND MORE ASPECTS THAT CAN AFFECT THE VALUES OF PERFORMANCE. REPORTED DATA HAVE BEEN CALCULATED ON THE BASE OF ROOF NOT HIGHER THAN 3 MTS.

THE MANUFACTURER RESERVES THE RIGHT TO MAKE CHANGES WITHOUT PREVIOUS NOTICE.

THERMOROSSI S.p.A.

Via Grumolo, 4 | 36011 Arsiero (VI) | Italy | E-mail: info@thermorossi.it

Tel: 800.44.88.77 | Fax: 0445 741657 | P.IVA 00168470243 | Iscr. REA99797 Vicenza | Cap. Sociale di 156,000,00 I.v.